

# STX AND SMX MODELS ADDRESSABLE FIRE ALARM SYSTEMS



**Honeywell**

MORLEY IAS  
FIRE SYSTEMS

# THE RELIABILITY AND SIMPLICITY OF HONEYWELL MORLEY-IAS, NOW AT YOUR FINGERTIPS

The Honeywell Morley-IAS range now comes with a compact, high-performance, feature-rich, fire alarm system that is suitable for installers and end users who are looking for a solution that is **simple, smart, secure** and is suitable for a wide range of applications.

The Honeywell Morley-IAS STX and SMX models UL-listed fire alarm control panels are easy to install and commission, promote cost savings and maximize productivity.

The STX and SMX models meet the requirements of the latest codes and standards (UL 864, 10<sup>th</sup> edition).



Just fix the panel to the wall, **connect the field wiring devices** and power up the panel for a working fire alarm system.



The user can **easily choose the default configuration** based on intelligent auto detection of the circuit or restore to quick customization via an intuitive interface.



Programming the control panel is easier because of the **large touch-based LCD** which provides a clear menu structure—making the initial setup process quick, clear and intuitive.



Complex **configuration is made easy** by using the mobile and PC tool application through **Bluetooth**.

**The ideal fire safety solution for performance conscious establishments.**

## KEY FEATURES AND BENEFITS

**Supports up to 159 detectors and 39 modules per loop**  
(up to 636 detectors and 156 modules with the 4-loop panel)

**Single replaceable part (HW Module Unit)** for quick repairs, reduced maintenance costs & minimized downtime



**Mobile & PC apps with guided setup / programming** via Bluetooth, resulting in up to 75% less commissioning time



Intuitive arrangement of controls for **prompt user action**



Complies with **latest codes and standards** (UL 864 10<sup>th</sup> edition)



Ability to **configure panels offline, remotely and sync via USB**, thus eliminating the need to carry laptops / tools to the site



Designed to deliver on **expanding mid-market performance and facility needs**, e.g. increasing number of zones



**Unified panel fascia** designed to comply with regulations globally



**Easy to install** with pluggable interface connectors and circuit auto-learn



**Contemporary HMI interface** with a 5-inch multi-color touch screen for exemplified monitoring and control – enhanced readability (location labels, events, etc.), context-awareness and easy navigation

## Available in red and grey color

PART CODE	DESCRIPTION
615-000-002	STX 1 loop panel supporting up to 98 devices in a grey color plastic enclosure
615-000-102	STX 1 loop panel supporting up to 198 devices in a grey color plastic enclosure
615-000-202	STX 2 loop panel supporting up to 396 devices in a grey color plastic enclosure
615-000-002-R	STX 1 loop panel supporting up to 98 devices in a red color plastic enclosure
615-000-102-R	STX 1 loop panel supporting up to 198 devices in a red color plastic enclosure
615-000-202-R	STX 2 loop panel supporting up to 396 devices in a red color plastic enclosure
915-100-102	SMX 1 loop panel supporting up to 198 devices in a grey color metal enclosure
915-100-202	SMX 2 loop panel supporting up to 396 devices in a grey color metal enclosure
915-100-402	SMX 4 loop panel supporting up to 792 devices in a grey color metal enclosure
915-100-102-R	SMX 1 loop panel supporting up to 198 devices in a red color metal enclosure
915-100-202-R	SMX 2 loop panel supporting up to 396 devices in a red color metal enclosure
915-100-402-R	SMX 4 loop panel supporting up to 792 devices in a red color metal enclosure



STX Model

SMX Model

## Honeywell Morley-IAS SmartConfig™ – How Does It Work?

Honeywell Morley-IAS SmartConfig™ is the application for configuring / commissioning STX and SMX model fire alarm control panels. Both mobile and PC versions of the application are available.



1 Launch the Honeywell Morley-IAS SmartConfig™ mobile application.



2 Establish a bluetooth connectivity between mobile application and Fire Alarm Control panel.

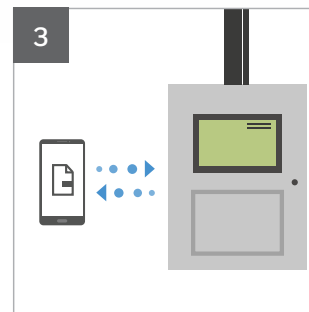

3 Configure the Fire Alarm Control Panel using™ QuickWizard.



4 Voila! The Fire Alarm Control Panel is configured.

- Program the panel from your laptop, mobile, or directly from the panel HMI.
- Use application's Quick Wizard to configure your panel in minutes.
- Work with your configuration in the application while on-site or even off-site.
- Easily discover the difference between existing (or default auto-learn) and new configuration to choose what to keep.
- Sync configuration via Bluetooth or USB pen drive (no cables required).

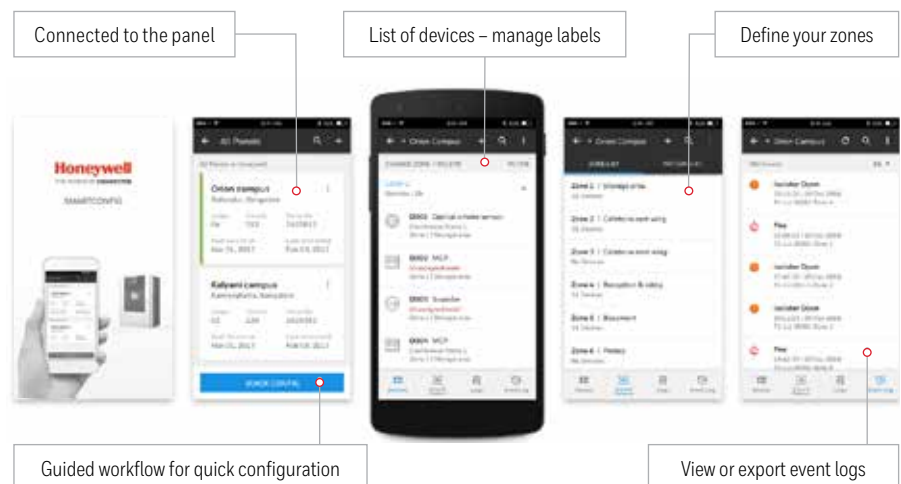

 **DOWNLOAD NOW**  
Honeywell Morley-IAS SmartConfig



## Detectors & Specialist Devices

The Honeywell Morley-IAS comprehensive range of sensors, modules and audio/visual devices provide the designer with the flexibility to Install up to 198 detectors / devices (up to 159 detectors & 39 devices) on each loop and in the right mix to effectively meet application requirements. The list below details some of the field devices that can be used with the STX and SMX model fire panels.

### Intelligent, Addressable Detectors

- **Multi-criteria Sensor:** Uses a combination of different sensing technologies including smoke and heat.
- **Photoelectric Sensor:** Uses photoelectric sensing chamber to detect fire through the presence of smoke.
- **Heat Sensor:** Measures the temperature of surroundings to detect a fire due to an increase in temperature or a rapid rate of rise in temperature.
- **Manual Call Point:** Used to raise an alarm manually.



PART CODE	DESCRIPTION
HM-PTSE-UL	Multi-criteria Smoke Detector
HM-PSE-UL	Photoelectric Smoke Detector
HM-FHSE-UL	Fixed Thermal Detector
HM-RHSE-UL	Fixed Thermal with Rate-of-Rise
HM-HTSE-UL	High Heat Detector
BEAM355	Beam Smoke Detector
HM-MCP-GLASS-UL	Addressable Manual Call Point

### Input / Output Modules

Allow other fire detection or sensing equipment to be interfaced with the control panel, e.g. sprinkler flow switch or a relay to “ground” a lift.



Addressable Control Module (HM-DCMO-UL)

PART CODE	DESCRIPTION
HM-DMMI-UL	Monitor Module
HM-MM3E-UL	Mini-Monitor Module
HM-DCZRM-UL	Interface Module
HM-DCMO-UL	NAC Control Module
HM-D240CMO-UL	Relay Control Module
HM-DISO-UL	Isolator Module

### Annunciator / LED Driver

The LCD annunciator allows to monitor & control the Fire Alarm Control Panel (FACP) from areas away from the panel whereas the LED driver module is used to drive the most customized graphical annunciators.



LCD Annunciator (315-080)

LED Driver (315-040)

PART CODE	DESCRIPTION
315-080	LCD fire annunciator that mimics the FACP
315-040	LED driver for customized graphic annunciators

### For more information

[www.morley-ias.co.uk](http://www.morley-ias.co.uk)

### Honeywell Building Technologies ASEAN

Level 25, UOA Corp Tower B, Avenue 10  
The Vertical, Bangsar South City  
59200, Kuala Lumpur, Malaysia  
Email: [Buildings.ASEAN@Honeywell.com](mailto:Buildings.ASEAN@Honeywell.com)

### Honeywell Building Technologies India

Unitech Trade Centre, 5th Floor  
Sector – 43, Block C, Sushant Lok Phase – 1  
Gurgaon – 122002, Haryana, India  
Email: [HoneywellSecurity&Fire@Honeywell.com](mailto:HoneywellSecurity&Fire@Honeywell.com)  
Toll Free: 1-800-103-0339  
[www.honeywell.com](http://www.honeywell.com)

### Honeywell Building Technologies META

Emaar Business Park, Building 2, 2<sup>nd</sup> Floor  
Sheikh Zayed Road  
P.O.Box 232362, Dubai, U.A.E.  
Phone: +971 4 4505 847